

iR C3020

QUALITY MEETS SIMPLICITY

Key Highlights:

- Two 550-sheet paper cassettes
- 100-sheets Multi Purpose Tray
- **5 inch** TFT LCD WVGA Colour Touch panel
- Memory: **2GB RAM**
- Processor: **800 MHz Dual**
- PDL: **UFR II (optional PCL & PS3)**
- **Direct Print TIFF/JPEG/PDF/XPS**
- **Standard Wi-Fi**
- **Direct Access Point**
- **Searchable PDF**
- **Smart Scan (Text orientation recognition during scan)**
- **300** Department IDs
- Supports **uniFLOW**
- Supports **Canon Print Business**, Canon Print Service, **Google Cloud Print** and **AirPrint™**

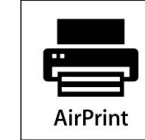

Media Support & New Panel



Media Adjustment Kit

	▼106gsm	▼220gsm	▼256gsm	▼300gsm
Heavy	✓	✓	✓	
Coated	✓	✓	Requires Media Adjustment Kit	



Soft-closing Cassette



New

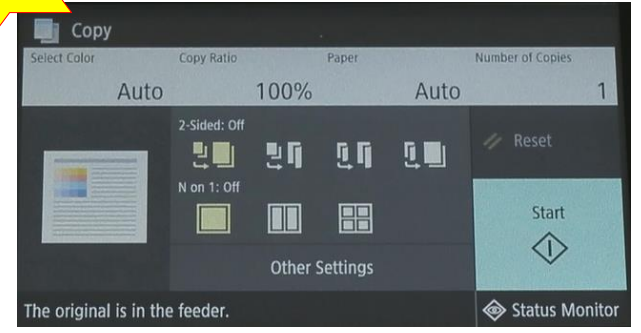

Soft keyboard keys



Soft numeric keys

- > Supported weights : 220 gsm from cassette, 300 gsm from MPT
- > 12 x 18 paper supported from cassette 2, 3, 4 & MPT
- > Indian legal Standard paper size from cassette 2, 3, 4 & MPT

USB memory media and Mobile printing

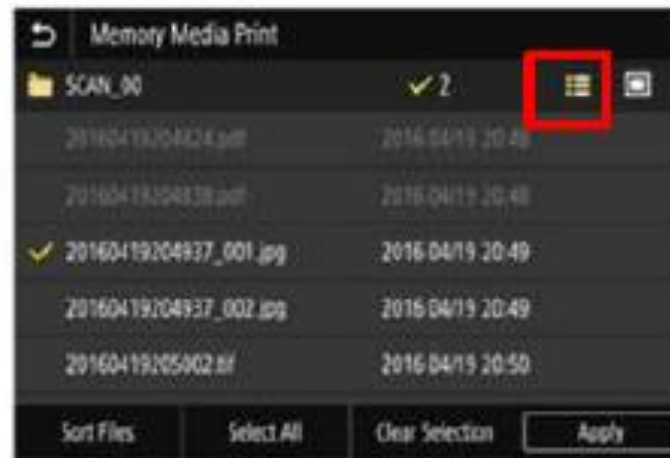
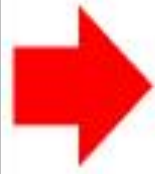
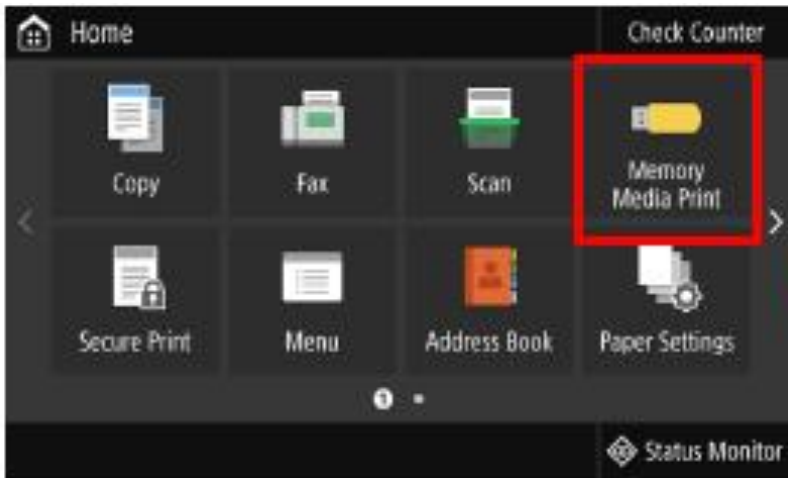
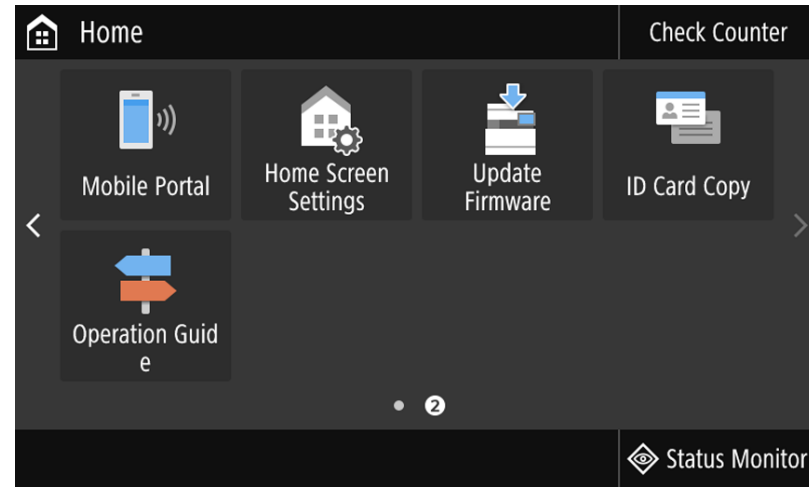

Secure Printing, Smart Scan & FAX

Secure Printing

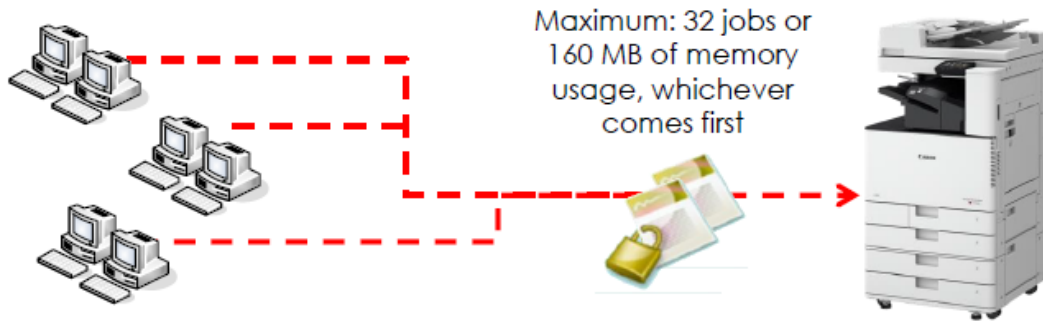

Searchable PDF



FAX forwarding

(with Opt. SUPER G3 FAX Board AV1)



Text Orientation Recognition

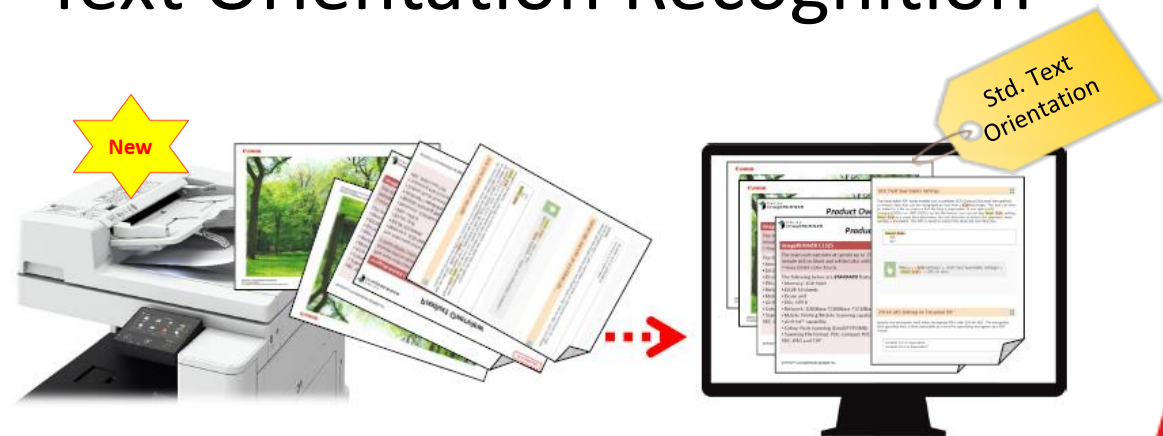

RMV and Consumables

Impression	iR C3020
Maximum Print/Copy volume	16,000
Machine Life	1,000,000 (A4) or 5 years
Duty Cycle Rate *	77,000



NPG – 67 Toner (A4, 5% coverage)	Black	Yellow	Magenta	Cyan
	8524B001	8527B001	8526B001	8525B001
Yield	36,000		19,000	

NPG-67 Drum Yield			
Black	Yellow	Magenta	Cyan
8524B001			
69,000	54,000		



Competitor Comparison

	Canon imageRUNNER C3020	Konica Minolta bizhub C221	Ricoh MP C2011SP
First Copy Time	8.2 sec color/5.9 sec black	10.2 sec color/7.8 sec black	7.7 sec color/5.5 sec black
Multicopy (Ltr/Lgl/Ldgr)	20 cpm color/20 cpm black	22 cpm color/22 cpm black	20 cpm color/20 cpm black
Warm-up Time	30 sec	38 sec	19 sec
Std Paper Capacity	550/550 sheets	500/500 sheets	550/550 sheets
Bypass/Paper Weights	100-sheet/52 to 300 gsm	150-sheet/60 to 300 gsm	100-sheet/52 to 300 gsm
System Memory	2-GB RAM	2-GB RAM	1.5-GB RAM, 250-GB HD
SECURITY SPECS	Department ID authentication		
CONTROL PANEL	127 mm color touchscreen	Keypad	Keypad and 228.6 mm color touchscreen
Max Power Consumption	1500W	1580W	1700W
Consumables - Black Toner	Black toner; Yield: 36,000	Black toner; Yield: 27,000	Black toner; Yield: 15,000
Consumables - Color Toner	Cyan/Magenta/Yellow Toner; Yield: 19,000	Cyan/Magenta/Yellow Toner; Yield: 25,000	Cyan/Magenta/Yellow Toner; Yield: 9,500
Consumables - Black Drum	Black drum; Yield: 69,000	Black drum; Yield: 70,000	Black drum; Yield: 60,000
Consumables - Colour Drum	Cyan/Magenta/Yellow drum; Yield: 54,000	Cyan/Magenta/Yellow drum; Yield: 55,000	Cyan/Magenta/Yellow drum; Yield: 48,000
USB Interface	Std 2.0, std 2.0 (host) x 2	Std 2.0, std 1.1, std (host)	Std 2.0, std 2.0 (host)
Network Interface	Std Ethernet, Std wireless	Std Ethernet	Std Ethernet, opt wireless
Unenhanced Resolution	1200 x 1200 dpi	600 x 600 dpi	1200 x 1200 dpi
Technology/Scan Speed	Proprietary image sensor/30 ipm color, 55 ipm black	CCD/22 ipm color, 22 ipm black	CCD/54 ipm color, 54 ipm black

iR-ADV C3320 v/s iR C3020



V2 (VIVID & VIBRANT)	COLOR TECHNOLOGY	V2 (VIVID & VIBRANT)
2 GB	RAM	2 GB
250 GB	HARD DISK	NOT APPLICABLE
OPTIONAL	DADF	OPTIONAL
7" COLOR TILTABLE TOUCH SCREEN	SCREEN SIZE	5" COLOR TOUCH SCREEN
550 + 550 + 100	PAPER CAPACITY	550 + 550 + 100
52 to 220 gsm	PAPER WEIGHTS CASSETTE	52 to 220 gsm
52 to 256 gsm (300 gsm support optional)	PAPER WEIGHTS MPT	52 to 300 gsm
A3, A4, INDIAN LGL & 12x18	PAPER SIZE FROM CASSETTE 2	A3, A4, INDIAN LGL & 12x18
A3, A4, INDIAN LGL, SRA3 & 12x18	PAPER SIZE FROM MPT	A3, A4, INDIAN LGL, SRA3 & 12x18
NO	SUPPORT FOR 13X19 SIZE	NO
ETHERNET	CONNECTIVITY	ETHERNET & WiFi (Connect mobile devices directly using QR Code)
JPEG & TIFF (PDF & XPS OPTIONAL)	PRINT FROM USB	JPEG, TIFF, PDF & XPS
MEAP	SOFTWARE PLATFORM	NOT APPLICABLE
BLACK: 69,000 COLOR: 54,000	DRUM YIELD	BLACK: 69,000 COLOR: 54,000
BLACK: 36,000 COLOR: 19,000	TONER YIELD	BLACK: 36,000 COLOR: 19,000
WALKTHROUGH VIDEOS	ADDITIONAL FEATURES	WALKTHROUGH ANIMATIONS
REMOTE OPERATOR SOFTWARE KIT		SEARCHABLE PDF
COPY AREA DESIGNATION		SMART SCAN

